

Props:
Spray bottle

Costumes:
Casandra's 15 person

Other:

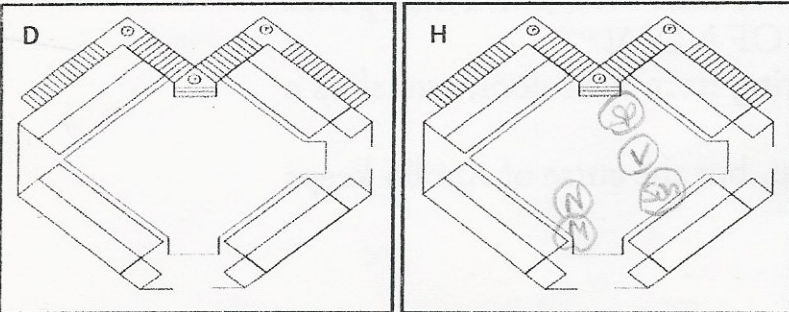
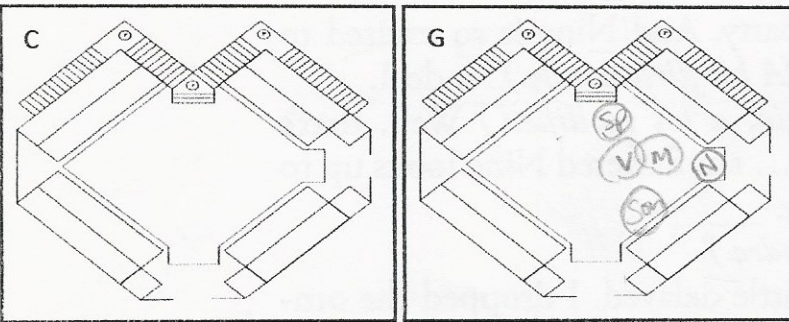
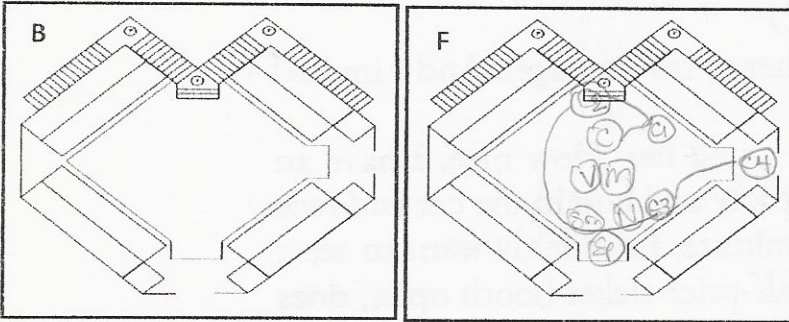
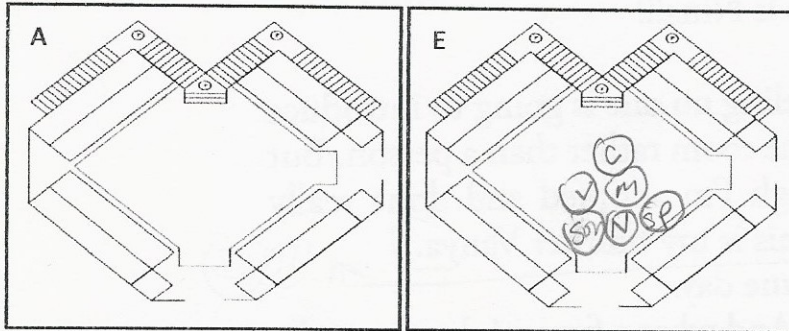

1. C X to sofa & spritz

2.

3. C Reset H @ DTT

4.

5. C Spritz plant

6. C counter sp

7. C Spritz plant

8.

9.

10. C Ex @ 30C

11.

12. N X to 30C & SP X to DTT

13.

14. M R & X & confront sp

15.

16. N X to puzzle table 75

17.

18. M & sp meet @ DTT

19.

20.

everyone from acting on my warnings. (*Feels drawn to make a bit of a speech.*)

E

① Oh mystery and misery, descends upon me like a thunder cloud,
Pregnant with rain and Jupiter's arrows.

The terrible burden of true prophecy, of my unwanted but
unstoppable prelude.

Look out, look out — all around us are lions and tigers and bears.
Oh my, the omelette is a failure, I crush it beneath my foot.

③

The libation bearers bring guts and entrails
And parents' children chopped up and served in a shepherd's pie.
Something tastes wrong with it — little wonder!

F

⑤

Next time you won't go killing Agamemnon, will you?

He's already dead. My car needs to be inspected,

How can I keep all these facts in my head when I see calamity
and colossus

Lumbering up the walkway?

Oh wretches, oh misery, oh magical mystery tour.

⑩

Beware the future. I know you will not abide me,

You ignore because I am not tall.

⑦

But I am right! I see disaster ahead for all of you!

Lunch in about twenty minutes! (*She strides out.*)

G

⑩

NINA. Oh she's a wonderful actress, too. What was that from,
what she just recited?

⑫

MASHA. It was from one of the Greek tragedies, I think. But I
believe she embellished it slightly.

⑭

NINA. Tell me ... I wonder if this is a stupid question. But what is
the difference between acting in a movie and acting onstage?

H

⑩

MASHA. No, it's not stupid at all. In film, you are acting in front of
a camera, and you need to speak in a normal voice. And onstage, you
are in a sort of wooden box in front of people who are looking at you
and you must speak more loudly. So that they can hear you.

NINA. I see, yes. What was your favorite role onstage?

MASHA. My favorite role onstage. Well I loved all the Ibsen I did,
and the Chekhov, and the Shakespeare. Google me when you go
home. Besides I'm not the only actor in the room. Spike is wonder-

⑱

fully talented. He was almost cast in *Entourage 2*.

NINA. Yes, he told me.

MASHA. Spike, why don't you ... (*Suddenly notices he's still in his un-
derwear.*) Goodness, you're still in your underwear. Spike, dear, why